

Now the set is complete.

The foil bag system with high-performance dispenser



www.kettenbach.com

Plug & Press®

– Just a few simple moves are enough

The foil bag system from Kettenbach makes impressions even easier and more convenient. Plug & Press® is clean, reliable, fast and easy to use, and offers the minimum time requirement. The practical dispenser - a development of Kettenbach - which guarantees the maximum in user-friendly handling, completes the system. With Panasil® binetics putty, Panasil® tray, Monopren® transfer and Kettosil®, different viscosities, from medium to firm, can now be easily processed in the new Plug & Press® dispenser.



Thanks to its discharge force, the Plug & Press® dispenser enables significantly quicker filling of the tray.



Clean. Safe. Rapid.



1. Before using for the first time, remove the white safety pin from the activating head of the large foil bag by turning it in the direction of the arrow and pulling it out.



2. Insert the large foil bag with the integrated activating head into the cartridge body. Ensure that the notches on the activating head and cartridge body are aligned.



3. Press the activating head onto the cartridge body until it is fully closed. The foil bag is automatically pierced by a pin when the activating head is pressed in position. Follow the same procedure as in step 2 and step 3 with the smaller foil bag.

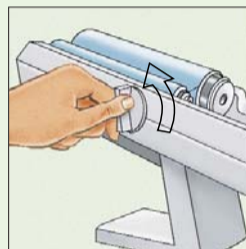

4. Move the plungers right to the top by turning the control knob, after you have connected the dispenser to electricity.

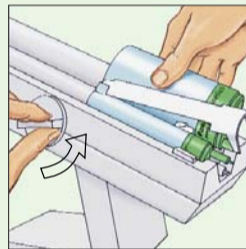

5. Insert the cartridge bodies into the unit.

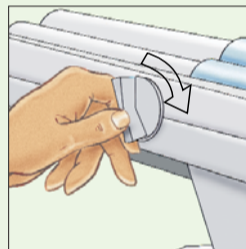

6. Turn the control knob to move the plungers into the cartridge bodies and continue turning until the plungers come into contact with the foil bags and the seal plungers of the cartridge. Once there is contact, press one of the two start keys (at the front on top of the unit) to dispense the material.



7. Before fitting the dynamic mixing tip, extrude the material until it exits uniformly, to ensure homogeneous mixing.



8. Do not fit the dynamic mixing tip and close the locking clip until this has been completed.

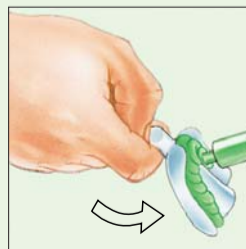

9. Fill the tray with the required amount of material. Hold the impression tray in a tilted position and press lightly against it. Leave the edge of the mixing tip in the material when dispensing. Leave the filled mixing tip on the cartridge body as a seal.



10. Simply remove the empty foil bags and activating heads from the cartridge body and dispose of them. The cartridge body is reused.

Panasil® binetics putty

The first real putty in a foil bag – Finally you will have the comfort you've always wanted. No more manual kneading, an exact dosage and an economical use of the material.

Clean, safe, rapid. And naturally, Panasil binetics putty meets the typical Kettenbach quality standards such as a brief intraoral setting time as well as neutral taste and odour. Available in two versions: Putty fast for taking two-step putty-wash impressions and Putty soft for the "Sandwich technique" – whatever you want.

Panasil binetics putty fast

Total working time:

1'30 min.

Intraoral setting time:

2'30 min.

Final set:

4'00 min.

Panasil binetics putty soft

Total working time:

2'00 min.

Intraoral setting time:

3'00 min.

Final set:

5'00 min.



Panasil® tray

Panasil tray is a high viscosity precision impression material available in „fast“ and „soft“ versions for creating the optimum conditions for taking impressions using tried and tested techniques. Panasil tray fast is a heavy body material with high final hardness values indicated specifically for taking two-step impressions and which is easily cut. Panasil tray soft exhibits low final hardness values and, as it is very firm, is especially indicated for taking one-step putty-wash impressions.

Panasil tray fast

Total working time:

1'20 min.

Intraoral setting time:

2'00 min.

Final set:

3'20 min.

Panasil tray soft

Total working time:

2'00 min.

Intraoral setting time:

2'00 min.

Final set:

4'00 min.



Monopren® transfer

As a medium viscosity monophase impression material, Monopren transfer offers considerable advantages for taking impressions over fixed/removable restorations and implants. Optimal elasticity, a high final hardness and setting in record time.

Thanks to its marked thixotropic properties, Monopren transfer guarantees the desired build-up of pressure and, at the same time, flows in a narrow line to the primary sections or impression posts.

In addition to the new Kettenbach foil bag system, Monopren transfer is also available in cartridge or standard tube formats.

Total working time:

2'00 min.

Intraoral setting time:

2'00 min.

Final set:

4'00 min.

Kettosil®

Kettosil, the „Silginat®“ for situation impression, combines the benefits of A-silicons and alginates in a single product, because Kettosil combines low tear resistance with high dimensional stability of the impression, so that the impression can be used several times over an extended period. Ideal requirements therefore for impressions for temporary crowns and bridges, for easily removable restorations or orthodontics.

Total working time:

1'20 min.

Intraoral setting time:

1'20 min.

Final set:

2'40 min.



Plug & Press® Packages

Panasil® binetics putty fast



Plug & Press Package 7 **REF 28187**
 1 Plug & Press Dispenser
 1 Economy Pack (6 x 300 ml Base, 6 x 62 ml Catalyst)
 1 Starter set (1 x 300 ml Base, 1 x 62 ml Catalyst, 1 Cartridge Body,
 10 Dynamic mixing tips)
 1 Economy Pack Panasil initial contact X-light (12 x 50 ml + 72 Mixing tips)

Panasil® binetics putty soft

Plug & Press Package 8 **REF 28188**
 1 Plug & Press Dispenser
 1 Economy Pack (6 x 300 ml Base, 6 x 62 ml Catalyst)
 1 Starter set (1 x 300 ml Base, 1 x 62 ml Catalyst, 1 Cartridge Body,
 10 Dynamic mixing tips)
 1 Economy Pack Panasil initial contact light (12 x 50 ml + 72 Mixing tips)

Panasil® tray fast



Plug & Press Package 10 **REF 28190**
 1 Plug & Press Dispenser
 1 Economy Pack (6 x 300 ml Base, 6 x 62 ml Catalyst)
 1 Starter set (1 x 300 ml Base, 1 x 62 ml Catalyst, 1 Cartridge Body,
 10 Dynamic mixing tips)
 1 Economy Pack Panasil initial contact X-light (12 x 50 ml + 72 Mixing tips)

Panasil® tray soft

Plug & Press Package 9 **REF 28189**
 1 Plug & Press Dispenser
 1 Economy Pack (6 x 300 ml Base, 6 x 62 ml Catalyst),
 1 Starter set (1 x 300 ml Base, 1 x 62 ml Catalyst, 1 Cartridge Body,
 10 Dynamic mixing tips)
 1 Economy Pack Panasil initial contact light (12 x 50 ml + 72 Mixing tips)

Monopren® transfer



Plug & Press Package 11 **REF 28191**
 1 Plug & Press Dispenser,
 1 Economy Pack (6 x 300 ml Base, 6 x 62 ml Catalyst)
 1 Normal Pack (2 x 300 ml Base, 2 x 62 ml Catalyst)
 1 Starter set (1 x 300 ml Base, 1 x 62 ml Catalyst, 1 Cartridge Body,
 10 Dynamic mixing tips)
 1 Normal Pack Panasil initial contact light (2 x 50 ml + 12 Mixing tips)

Kettosil®



Plug & Press Package 6 **REF 28166**
 1 Plug & Press Dispenser
 3 Economy Pack (18 x 300 ml Base, 18 x 62 ml Catalyst)
 1 Starter set (1 x 300 ml Base, 1 x 62 ml Catalyst, 1 Cartridge Body,
 10 Dynamic mixing tips)
 1x Triple Tray Quadrants (40 pieces)
 1x Triple Tray Anteriors (35 pieces)

Plug & Press® Dispenser



Plug & Press Dispenser **REF 35900**

Accessories

Dynamic mixing tips, 50 tips	REF 17253
Dynamic mixing tips, 200 tips	REF 17255
Cartridge body for Kettenbach impression materials in foil bags, 1 unit	REF 17744
Triple Tray quadrants	REF 17741
Triple Tray anteriors	REF 17742

For orders please contact your local dealer organization!

Not all devices are available in all markets. If you have questions, please contact our distributors.

Kettenbach GmbH & Co. KG, P.O.B. 11 61, 35709 Eschenburg/Germany, Tel.: +49 (27 74) 7 05-0,
 Fax: +49 (27 74) 7 05-33 www.kettenbach.com, E-Mail: info@kettenbach.de